

## SOD-323 贴片塑封开关二极管 200mW SOD-323 Fast Switching Diode

SOD-323

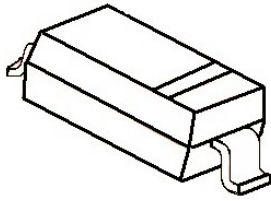

MARKING: C1

### 特征 Features

- 开关速度小; Fast Switching Device
- 最大功率耗散 200mW; Power Dissipation of 200mW
- 高稳定性和可靠性。High Stability and High Reliability
- 反向漏电流小。Low reverse leakage

### 机械数据 Mechanical Data

- 封装: SOD-323 封装 SOD-323 Small Outline Plastic Package
- 极性: 色环端为负极 Polarity: Color band denotes cathode end
- 环氧树脂 UL 易燃等级 Epoxy UL: 94V-0
- 安装位置: 任意 Mounting Position: Any

极限值和温度特性(TA = 25°C 除非另有规定)

**Maximum Ratings & Thermal Characteristics** (Ratings at 25°C ambient temperature unless otherwise specified.)

参数 Parameters	符号 Symbol	数值 Value	单位 Unit
反向电压 Reverse Voltage	VR	80	V
反向峰值电压 Peak Reverse Voltage	VRM	85	V
功率消耗 Power Dissipation	Pd	200(*)	mW
工作结温 Operating junction temperature	Tj	125	°C
存储温度 Storage temperature range	Ts	-55+125	°C
平均整流电流 Average Rectified Current	IO	100	mA
正向(不重复)电流 Non-repetitive Peak Forward Current	IFM	200	mA

Valid provided that electrodes are kept at ambient temperature.

(\*)Mounted on a glass epoxy circuit board of 20 X 20mm, pad dimension of 4 X 4mm

电特性 **Electrical Characteristics** (Ratings at 25°C ambient temperature unless otherwise specified).

符号 Symbols	参数 Parameter	测试条件 Test Condition	界限 Limits		单位 Unit
			Min	Max	
IR	反向漏电流 Reverse Leakage Current	VR1=30V VR2=80V	---	0.1 0.5	uA
VF	正向电压 Forward Voltage	IF=1mA IF=10mA IF=100mA	---	0.62 0.75 0.98	V
Trr	反向恢复时间 Reverse Recovery Time	IF= 10mA, VR=6V RL=100Ω	---	4	nS
C	结电容 Capacitance	VR=0.5V, f=1MHZ	---	3	pF

Typical Characteristics

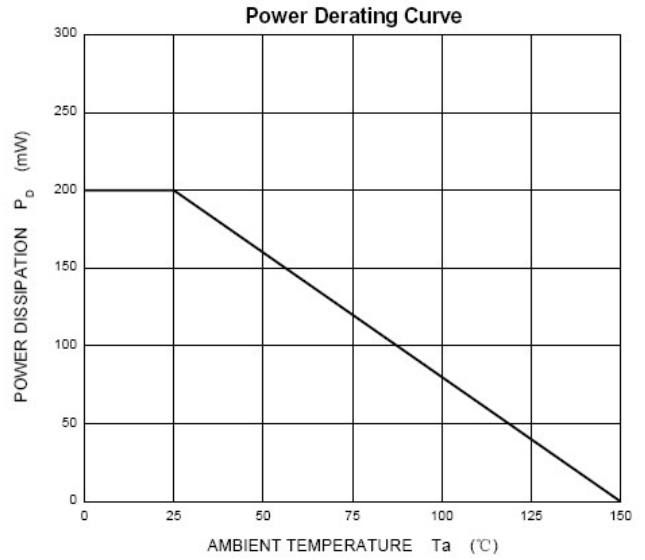
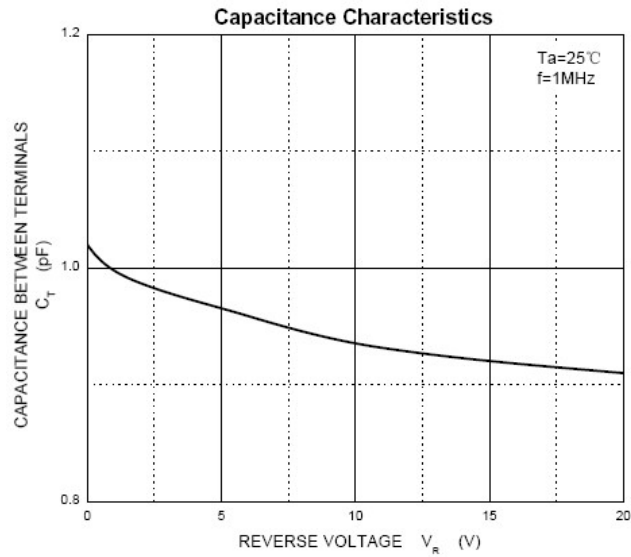
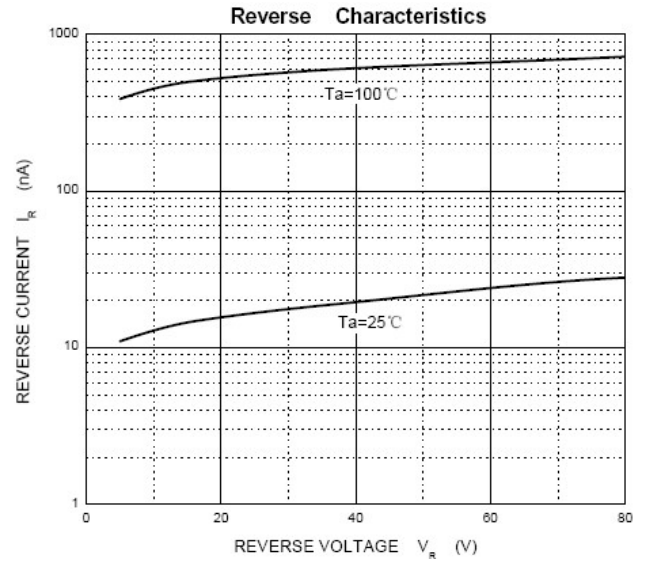
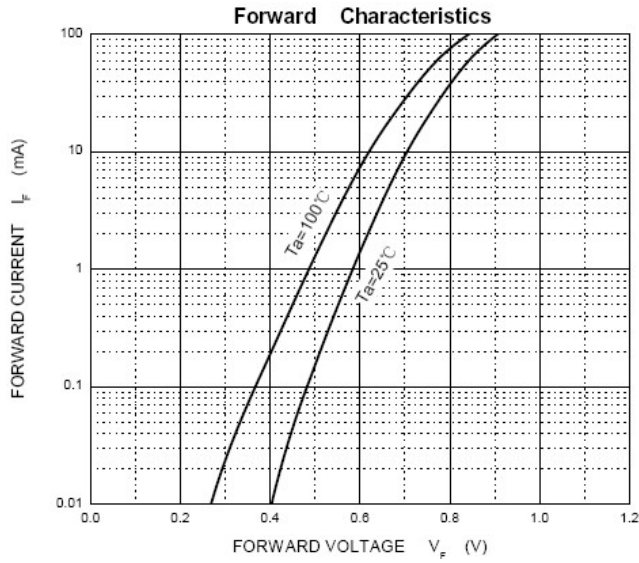

SOD-323 PACKAGE OUTLINE

Plastic surface mounted package

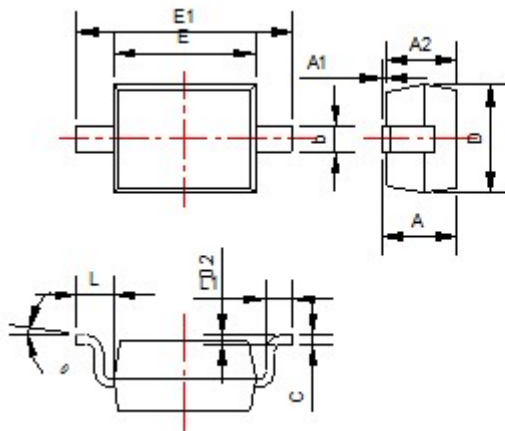

SYMBOL	DIMENSIONS	
	MIN.	MAX.
A		1.000
A1	0.000	0.100
A2	0.800	0.900
b	0.250	0.350
c	0.080	0.150
D	1.200	1.400
E	1.600	1.800
E1	2.500	2.700
L	0.475REF	
L1	0.250	0.400
$\theta$	0°	8°